

SCOPE

TRACK SERIES

A series of basic track mounted adjustable luminaires designed with ELR's modular concept. LED modules are fully interchangeable with choices to flexibly illuminate designated areas and objects ideally for accent lighting applications.



Future proof with upgradeable module

 Accessories options

Module Colour Temperature Variation



Beam Angle



Driver Dimming Variation



SCOPE 3 TRACK

TRACK MOUNTED LUMINAIRE



TECHNOLOGY AND FEATURES



Advanced Thermal Protection System



Low Flicker, No Risk (IEEE 1789)



Converging Optical Lens Maximising LOR

AVAILABLE OPTIONS

FIXTURE COLOUR OPTIONS

Trim Colour Options

Reflector Colour Options

MATT WHITE RAL9003

MATT BLACK RAL9011

MATT WHITE RAL9003



MATT BLACK RAL9011



ACCESSORIES



Honeycomb Anti-Glare Louvre



Soft Lens



Linear Spread Lens



MR16 Holder GU10 Holder

LED MODULE

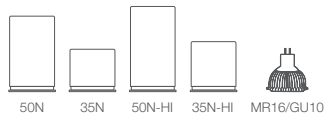

SINGLE CCT

2700K 3000K 3500K 4000K 5000K ProART ProART98

50N / 35N
50N-HI / 35N-HI



	10°	20°	35°	60°
50N / 35N	✓	✓	✓	✓
50N-HI / 35N-HI	✓			
WARM DIM	✓	✓	✓	✓
tuneWHITE				
flexiK		✓	✓	✓

***tuneWHITE and flexiK are recommended to be paired with Soft Lens for better colour mixing effect.*

DRIVER DIMMING



(ND)



(PH)



(AN)



(DA)

SCOPE 3
TRACK

SPECIFICATIONS

FITTURE

Family Type	Scope series
Fixture Colours	Matt white, matt black
Reflector Colours	Matt white, matt black
Fixture Materials	Aluminium
Accessories	Honeycomb anti-glare louvre, soft lens, linear spread lens
Ingress Protection	IP40

LED MODULE & DRIVER

Compatible LED Modules	50 and 35 NEST series LED modules or MR16/GU10
Lifetime	Up to 50,000 hours L80 lamp life with LM80 tested LED chip packages
Beam Angles	10°, 20°, 35°, 60°
Colour Temperatures	2700K, 3000K, 3500K, 4000K, 5000K, Warm Dim, tuneWHITE, flexiK
CRI	High Efficiency (CRI-85), ProART (CRI-95), ProART98 (CRI-98)
Driver (Dimming)	Non-dim, phase (leading & trailing edge), 0-10V, DALI

DIMENSIONS (MM)

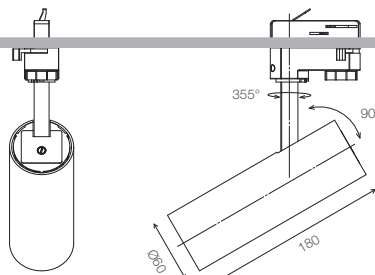

SCOPE 3 TRACK

PHOTOMETRICS

50 NEST

Height (m)		Emax (lx)			
		10°	20°	35°	60°
1	E(0°)	4723	3357	1974	763
	Cone Ø (m)	0.19	0.34	0.60	1.15
2	E(0°)	1181	839	494	191
	Cone Ø (m)	0.38	0.68	1.19	2.30
3	E(0°)	525	373	219	85
	Cone Ø (m)	0.57	1.03	1.79	3.45
4	E(0°)	295	210	123	48
	Cone Ø (m)	0.76	1.37	2.38	4.60
5	E(0°)	189	134	79	31
	Cone Ø (m)	0.95	1.71	2.98	5.75

Correction Factor:
 50N (10°) - f = 1.00 50N (20°, 35°, 60°) - f = 1.00
 35N (10°) - f = 0.73 35N (20°, 35°, 60°) - f = 0.74

ELR LED Module				50N	35N			
LED Power				7.5W	5.5W			
System Power				10W	7.5W			
Luminous Flux (lm)	Single CCT (3000K)	Type	Beam Angle	CRI				
				High Efficiency Ra-85	ProART Ra-95			
		10°	High Efficiency Ra-85	623		457		
				530		388		
				436		320		
				20°	High Efficiency Ra-85	884		651
						751		553
						618		456
		35°	High Efficiency Ra-85	893		658		
				760		559		
				625		461		
		60°	High Efficiency Ra-85	912		672		
776				571				
638				470				

Data are based on 3000K (ProART CRI-95). Nominal data of 2700K and 3500K are shared with 3000K. Higher CCT of 4000K and 5000K will have a nominal data value of 5% higher than published. (f = 1.05)
 High Efficiency CRI-85 will have a nominal data value of 15% higher than published. (f = 1.17)
 ProART98 CRI-98 will have a nominal data value of 8% lower than published. (f = 0.92)

Nominal CRI-85, equals to Ra>80-87, R9>0
 Nominal CRI-95, equals to Ra>90-97, R9>50
 Nominal CRI-98, equals to Ra>97-99, R9>93

50 NEST WARM DIM

Height (m)		Emax (lx)			
		10°	20°	35°	60°
1	E(0°)	4043	3328	1957	757
	Cone Ø (m)	0.27	0.34	0.60	1.15
2	E(0°)	1011	832	489	189
	Cone Ø (m)	0.53	0.68	1.19	2.30
3	E(0°)	449	370	217	84
	Cone Ø (m)	0.80	1.03	1.79	3.45
4	E(0°)	253	208	122	47
	Cone Ø (m)	1.07	1.37	2.38	4.60
5	E(0°)	162	133	78	30
	Cone Ø (m)	1.33	1.71	2.98	5.75

Correction Factor:
 50N WD - f = 1.00
 35N WD - f = 0.74

ELR LED Module				50N	35N
LED Power				7.5W	5.5W
System Power				10W	7.5W
Luminous Flux (lm)	Warm Dim (3100K)	Type	Beam Angle	CRI	
				ProART Ra-95	
		10°	664		490
			744		549
		20°	752		555
			768		566

Data are based on maximum output at 3100K
 Nominal CRI-95, equals to Ra>90-97, R9>50

SCOPE 3 TRACK

PHOTOMETRICS

50 NEST tuneWHITE/flexiK

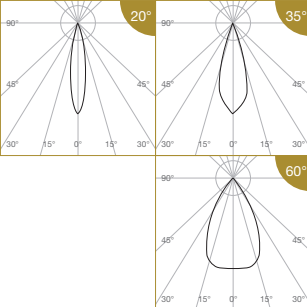

Height (m)		Emax (lx)			ELR LED Module				50N		
		20°	35°	60°	LED Power		System Power		Luminous Flux (lm)	Type	Beam Angle
1	E(0°)	2496	1468	568	7.5W		10W				
	Cone Ø (m)	0.34	0.60	1.15							
2	E(0°)	624	367	142	7.5W		10W		tuneWHITE / flexiK (4000K / 6500K)	35°	
	Cone Ø (m)	0.68	1.19	2.30							
3	E(0°)	277	163	63	7.5W		10W		tuneWHITE / flexiK (4000K / 6500K)	60°	
	Cone Ø (m)	1.03	1.79	3.45							
4	E(0°)	156	92	35	7.5W		10W		tuneWHITE / flexiK (4000K / 6500K)	60°	
	Cone Ø (m)	1.37	2.38	4.60							
5	E(0°)	100	59	23	7.5W		10W		tuneWHITE / flexiK (4000K / 6500K)	60°	
	Cone Ø (m)	1.71	2.98	5.75							

Data are based on maximum output at highest CCT (4000K / 6500K).
2700K will have a nominal data value of 10% lower than published. (f = 0.90)
1800K will have a nominal data value of 30% lower than published. (f = 0.70)
Nominal CRI-95, equals to Ra>90-97, R9>50

50 NEST HIGH INTENSITY

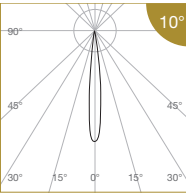

Height (m)		Emax (lx)		ELR LED Module				50N-HI	35N-HI	
		10°	10°	LED Power		System Power		Luminous Flux (lm)	Type	Beam Angle
1	E(0°)	10197	10197	7.5W		10W				
	Cone Ø (m)	0.19	0.19							
2	E(0°)	2549	2549	7.5W		10W		Single CCT (3000K)	10°	
	Cone Ø (m)	0.37	0.37							
3	E(0°)	1133	1133	7.5W		10W		Single CCT (3000K)	10°	
	Cone Ø (m)	0.56	0.56							
4	E(0°)	637	637	7.5W		10W		Single CCT (3000K)	10°	
	Cone Ø (m)	0.74	0.74							
5	E(0°)	408	408	7.5W		10W		Single CCT (3000K)	10°	
	Cone Ø (m)	0.93	0.93							

Data are based on 3000K (ProART CRI-95). Nominal data of 2700K and 3500K are shared with 3000K.
Higher CCT of 4000K and 5000K will have a nominal data value of 5% higher than published. (f = 1.05)
High Efficiency CRI-85 will have a nominal data value of 15% higher than published. (f = 1.17)
ProART98 CRI-98 will have a nominal data value of 8% lower than published. (f = 0.82)
Nominal CRI-85, equals to Ra>80-87, R9>0
Nominal CRI-95, equals to Ra>90-97, R9>50
Nominal CRI-98, equals to Ra>97-99, R9>83

Correction Factor:
50N-HI - f = 1.00
35N-HI - f = 0.73

SCOPE 3 TRACK

ORDERING MATRIX CHART

Type	Fixture				Accessories	
	Colour		Reflector Colour			
SCOPE-3TR	WH	Matt White	WH	Matt White	N	None
	MB	Matt Black	MB	Matt Black	AGL	Anti-Glare Louvre
					SL	Soft Lens
					LSL	Linear Spread Lens
					MR16	MR16 Holder
					GU10	GU10 Holder

Single CCT LED Module						Driver		Track Adapter							
LED Power		Beam Angle		Colour Temp		CRI		Dimming		Type					
ELR50N	7.5W	10	10°	27	2700K	HE	Ra-85	ND	Non-Dim	3AC	3 Circuit AC				
ELR35N	5.5W	20	20°	30	3000K	PA	ProART	PH	Phase	3AC	3 Circuit AC				
		35	35°	35	3500K			AN	0-10V	1DT	1 Circuit AC + Data				
		60	60°	40	4000K					3DT	3 Circuit AC + Data				
				50	5000K					DA	DALI	1DT	1 Circuit AC + Data		
								3DT	3 Circuit AC + Data						
								LBA	Local Brightness Adjuster	3AC	3 Circuit AC				
ELR50N-HI	7.5W	NS	10°	27	2700K	HE	Ra-85	ND	Non-Dim	3AC	3 Circuit AC				
ELR35N-HI	5.5W			30	3000K			PA	ProART	PH	Phase	3AC	3 Circuit AC		
				35	3500K					PP	ProART98	AN	0-10V	1DT	1 Circuit AC + Data
				40	4000K									3DT	3 Circuit AC + Data
				50	5000K									DA	DALI
								3DT	3 Circuit AC + Data						
								LBA	Local Brightness Adjuster	3AC	3 Circuit AC				
Warm Dim LED Module						Driver		Track Adapter							
LED Power		Beam Angle		Colour Temp		CRI		Dimming		Type					
ELR50N	7.5W	10	10°	WD	Warm Dim	PA	ProART	PH	Phase	3AC	3 Circuit AC				
ELR35N	5.5W	20	20°					AN	0-10V	1DT	1 Circuit AC + Data				
		35	35°							3DT	3 Circuit AC + Data				
		60	60°							DA	DALI	1DT	1 Circuit AC + Data		
								3DT	3 Circuit AC + Data						
tuneWHITE LED Module						Driver		Track Adapter							
LED Power		Beam Angle		Colour Temp		CRI		Dimming		Type					
ELR50N	7.5W	20	20°	TW1831	tuneWHITE 1800K-3100K	PA	ProART	DA	DALI	1DT	1 Circuit AC + Data				
		35	35°	TW1840	tuneWHITE 1800K-4000K					3DT	3 Circuit AC + Data				
		60	60°	TW2765	tuneWHITE 2700K-6500K										
flexiK LED Module						Driver		Track Adapter							
LED Power		Beam Angle		Colour Temp		CRI		Dimming		Type					
ELR50N	7.5W	20	20°	FK##	flexiK	PA	ProART	PH	Phase	3AC	3 Circuit AC				
								AN	0-10V	1DT	1 Circuit AC + Data				
										3DT	3 Circuit AC + Data				
										DA	DALI	1DT	1 Circuit AC + Data		
								3DT	3 Circuit AC + Data						

denotes the first two digits of preferred CCT ranging from 1800K to 6500K by increment of 100K.

example: SCOPE-3TR.WH.WH.AGL.ELR50N.35.27.PA.PH.3AC

*Custom RAL colour options available.